

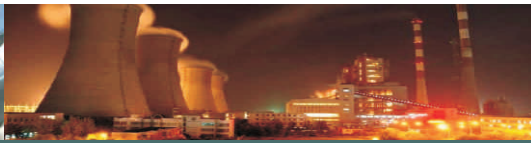

RUV SMALL SIZE BALL VALVE

IN POWER GENERATION



HIGH TEMPERATURE METAL SEATED BALL VALVE

CAB-17-01

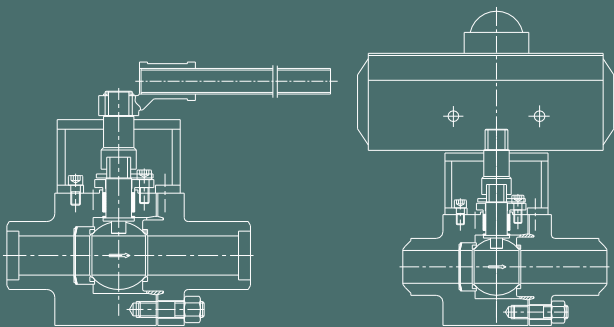

ROCKY UNION

RUV BALL VALVE IN POWER GENERATION

Rocky Union's Power Ball Valve joins a long list of proven products for power, including our forged bolted bonnet and pressure seal valves, bonnetless y-pattern globe valves, cast steel valves, small forged valves, and bimetallic steam traps. As a matter of fact, most of the different types of valves that RUV designs and manufactures have been sold into power plant applications.



POWER BALL VALVES IN POWER GENERATION

SIZE RANGE: 1/2"-4"

PRESSURE RANGE: ASME 900#, 1500#, 2500#, 4500#



- Attemperator Isolation Valves
- Boiler Feedwater Pump Recirculation
- Bottom Blow down
- Bypass Injector Isolation
- Cogeneration (Emergency Shutdown System)
- Condensate Drain Lines Above/Below
- Turbine Throttle Valves
- Feedwater Heater Isolation
- Feedwater Heater Drain
- Feedwater Heater Loop Drain
- Isolation Turbine Drains
- Low Pressure Turbine Drains
- Main Steam Drum Vents
- Main Steam Extraction Bleed Valves
- Nuclear
- Pressurized Fluidized Beds (PFB)
- Reheat Isolation
- Steam Trap Isolation
- Seal Steam Isolation
- Steam (Saturated/Superheated)

SUPERIOR DESIGN AND UNIQUE CONSTRUCTION

INTEGRAL ISO MOUNTING PAD FOR AUTOMATION

Allows for direct mount of actuator to valve without bolting/welding on required mounting bracket. Fully guided oversized stem prevents misalignment between the ball and actuator.

TWO-PIECES BOLTED BODY

INCONEL 750 LOAD RING

Maintains tight contact between seats and ball protecting seats in an open and closed position. Accommodates high temperature transients, allowing thermal expansion.

0 LEAKAGE SEALING INTEGRITY

Every Power Ball Valve meets the testing requirements of ASME B16.34. Each valve is subjected to hydrostatic shell and seat leakage tests in accordance with MSS-SP-61. RUV imposes a zero leakage criteria, which exceeds the standard. The Inconel ball and seat (typical hardness of Rc. 68) are chrome carbide coated by specially developed high velocity coating techniques that exceed the bond strength achieved by the standard HVOF process and are mated to perfection, ensuring resistance to wear and galling and long service life.

The operator can be gear box, pneumatic action, hydraulic action etc.

DOUBLE STEM BLOW OUT PROTECTION

High stem thrust from internal pressure is borne by external, life-lubricated bearing on stem shoulder. The split yoke bushing cannot be removed in-line. Secondary protection with stem shoulder against split gland bushing. Design precludes loading the stem to the point where it can push the ball rough the seat.

EMISSION FREE VALVE

An advanced packing chamber design with a two-piece self-adjusting gland bushing and live-loading provide long lasting, maintenance free, stem packing tightness.

SEAL WELDED DOWNSTREAM SEAT

High temperatures/pressures/flow rates are handled better by downstream seat anchored in place by seal weld.

ISOLATED BODY CAVITY

Ball and seats are in full contact all the time, isolating the body cavity from flow to prevent build-up of solids.

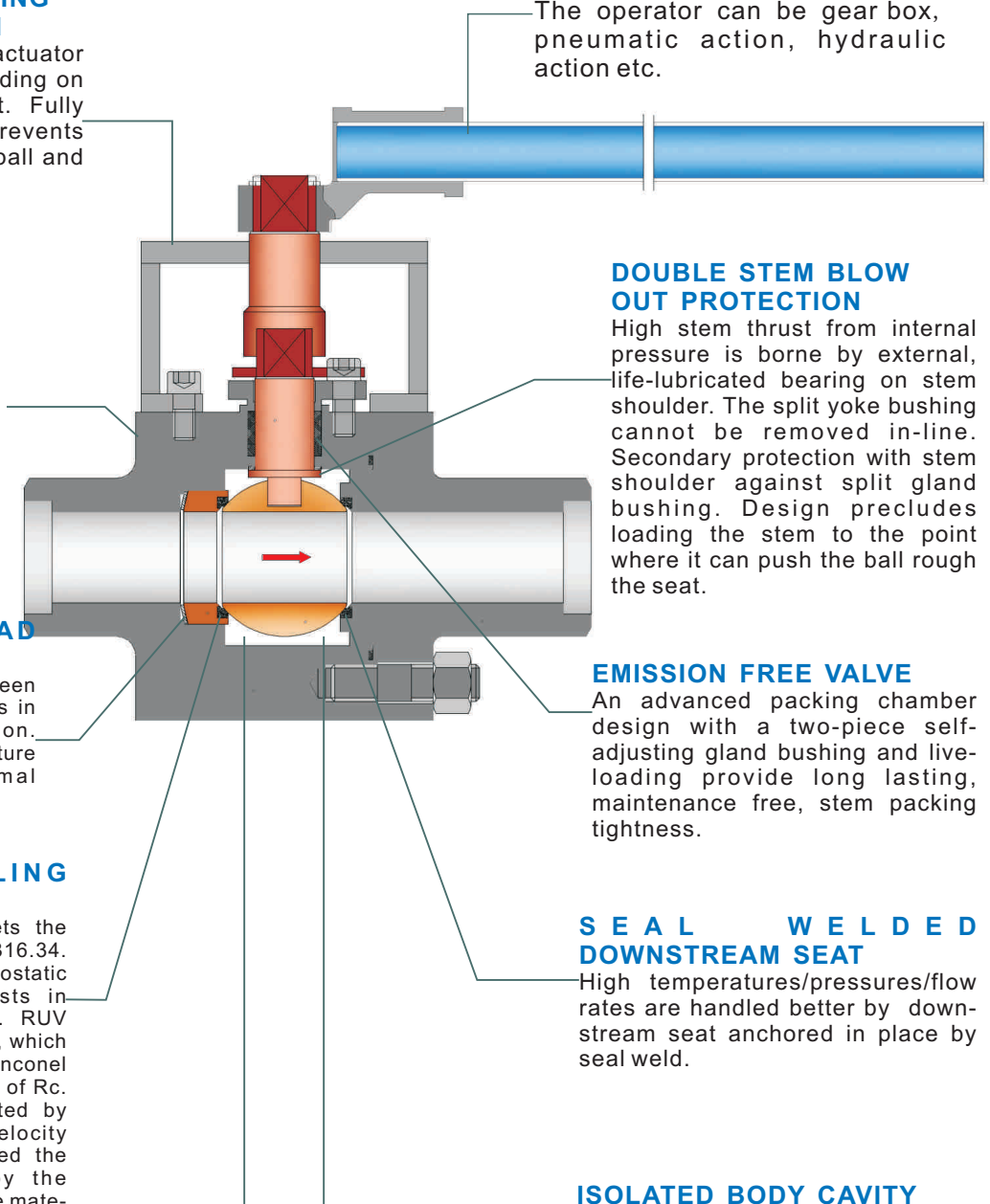

DYNAMIC DRAWING

RUV BALL VALVE IN POWER GENERATION

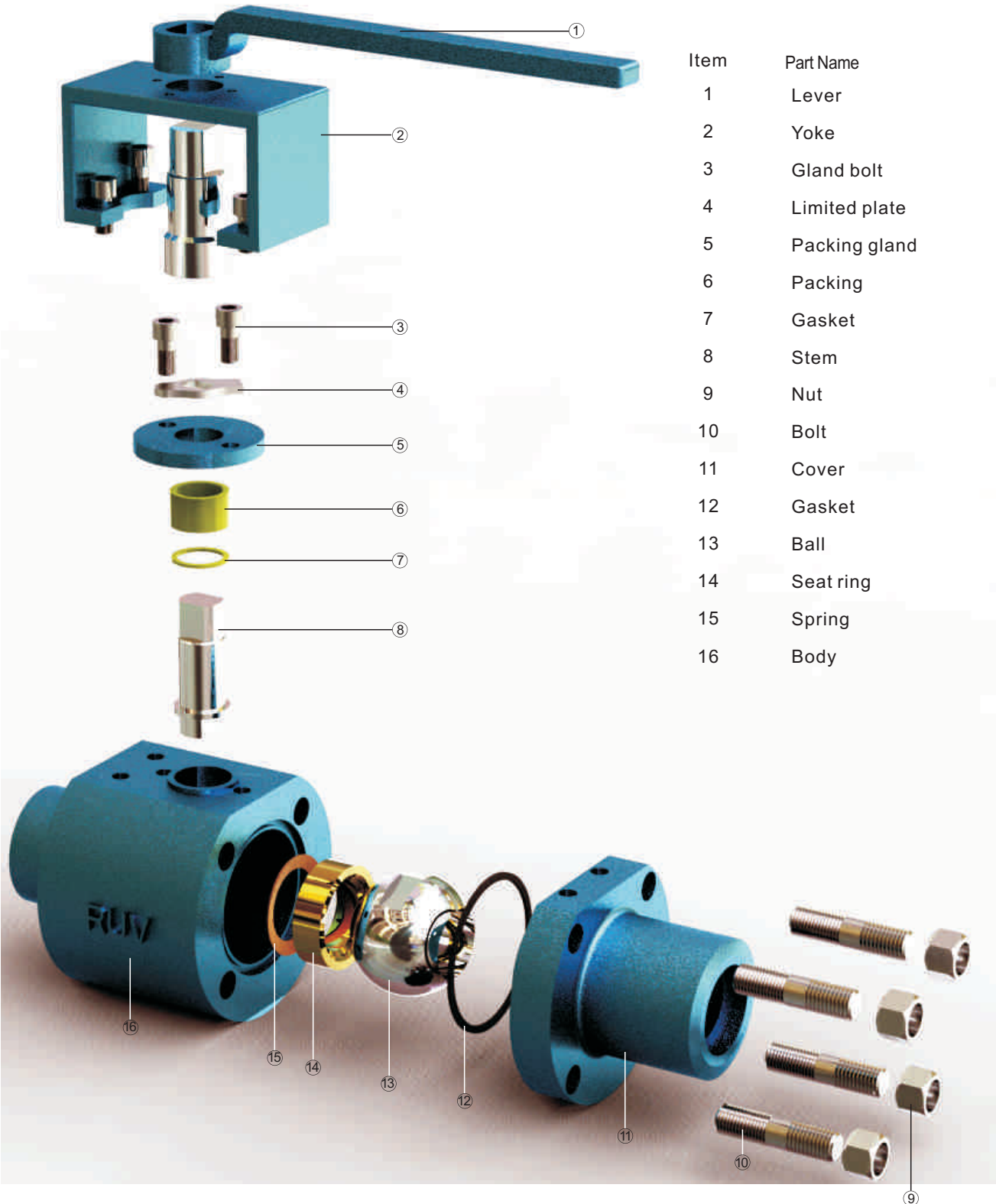

| Item | Part Name |
|------|---------------|
| 1 | Lever |
| 2 | Yoke |
| 3 | Gland bolt |
| 4 | Limited plate |
| 5 | Packing gland |
| 6 | Packing |
| 7 | Gasket |
| 8 | Stem |
| 9 | Nut |
| 10 | Bolt |
| 11 | Cover |
| 12 | Gasket |
| 13 | Ball |
| 14 | Seat ring |
| 15 | Spring |
| 16 | Body |

DIMENSIONS

(Regular Bore)

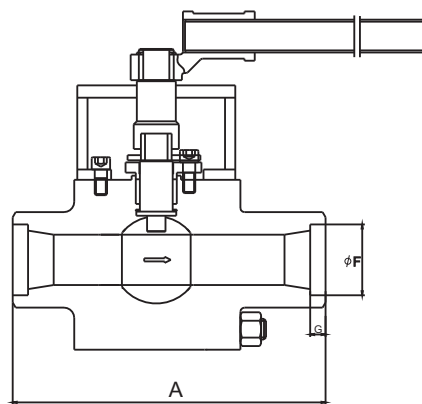
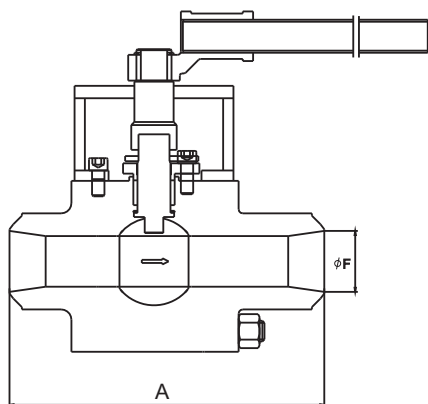

STANDARD DIMENSIONS, FLOW COEFFICIENT & WEIGHTS

| Size in mm | 1/2" 15 | 1/2" 15 | 3/4" 20 | 3/4" 20 | 1" 25 | 1" 25 | 1 1/4" 32 | 1 1/4" 32 | 1 1/2" 40 | 1 1/2" 40 | 2" 50 | 2" 50 | 2 1/2" 65 | 2 1/2" 65 | 3" 80 | 3" 80 | 4" 100 | 4" 100 | |
|------------|----------|---------|----------|---------|----------|-------|-----------|-----------|-----------|-----------|----------|-------|-----------|-----------|----------|-------|----------|--------|-----|
| Class | 900-2500 | 4500 | 900-2500 | 4500 | 900-2500 | 4500 | 900-2500 | 4500 | 900-2500 | 4500 | 900-2500 | 4500 | 900-2500 | 4500 | 900-2500 | 4500 | 900-2500 | 4500 | |
| A | BW | 216 | 254 | 254 | 273 | 273 | 292 | 273 | 305 | 305 | 368 | 305 | 368 | 368 | 381 | 381 | 405 | 405 | 451 |
| | SW | 216 | 254 | 254 | 273 | 273 | 292 | 273 | 305 | 305 | 368 | 305 | 368 | 368 | 381 | 381 | 405 | 405 | 451 |
| ϕF | 22.0 | 22.0 | 27.3 | 27.3 | 34.0 | 34.0 | 42.8 | 42.8 | 48.9 | 48.9 | 61.4 | 61.4 | 74.1 | 74.1 | - | - | - | - | |
| G | 10 | 10 | 13 | 13 | 13 | 13 | 13 | 13 | 13 | 13 | 16 | 16 | 16 | 16 | - | - | - | - | |

* For the full bore size dimensions, please contact RUV engineering.

PRESSURE-TEMPERATURE RATING

MATERIAL ASTM F22

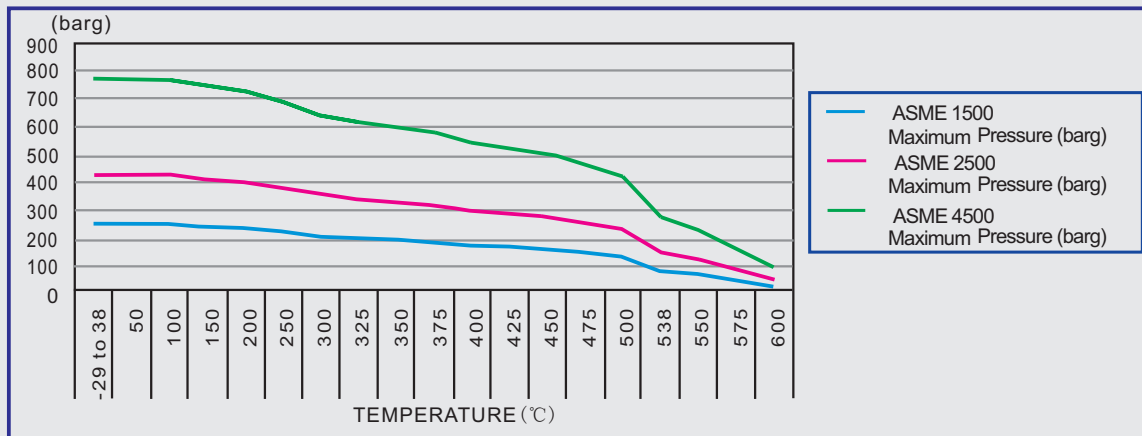

WE MAKE FOR RELIABILITY

ROCKY UNION VALVE CO.,LTD

Address: Chuannan SME Incubator, Bancang Industrial Park Hi-Tech
Development Area Zigong City, Sichuan People's Republic of China
Tel:+86-813-5536058 Fax:+86-813-5519412
E-mail: sales@rockyunion.com
rockyvalve@163.com
Website: www.rockyunion.com

Special Statement

ROCKY UNION is always committed to provide high quality products and efficient service to our customers, At the same time, we have always strictly abided by the provisions of the state; abided by the relevant international rules. And we also abide by the business and professional ethics, making effort to providing employees safety, healthy, environmental work environment.